

Benchtop Drawing

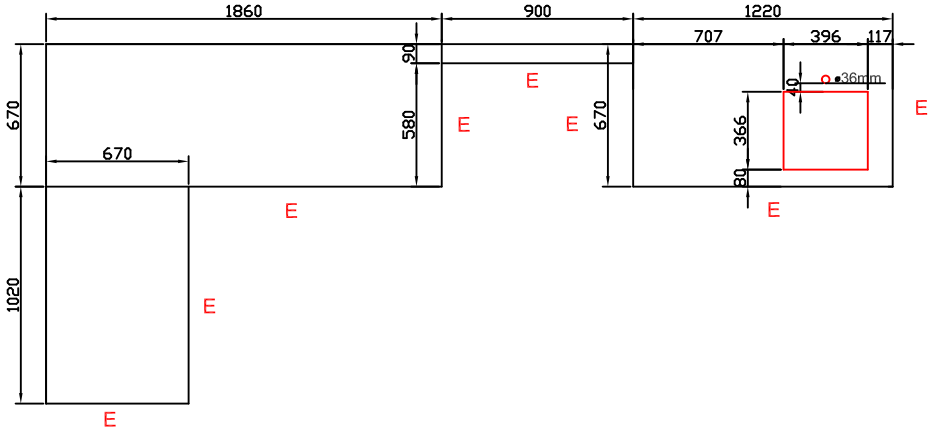

Plan view

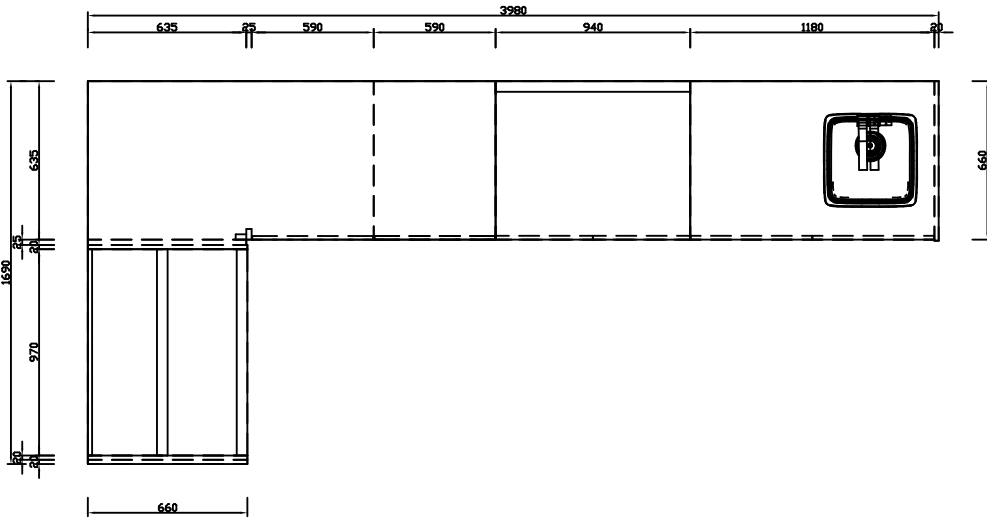

Internal view

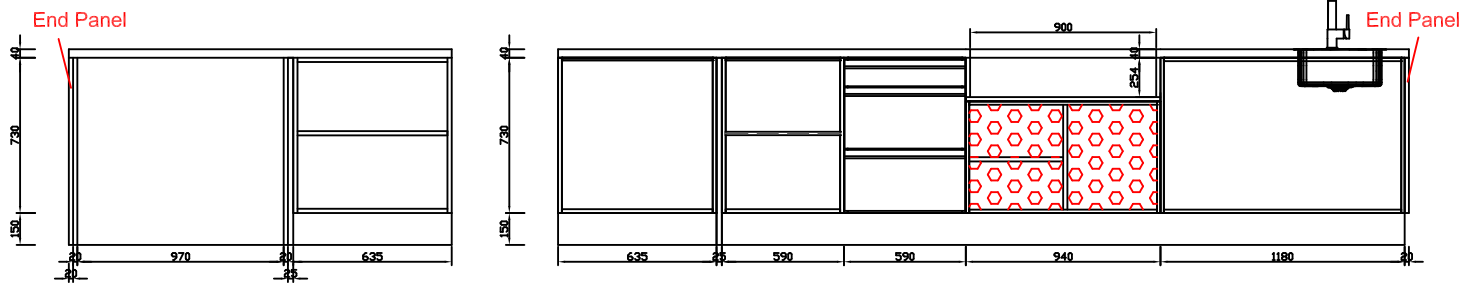

Front view

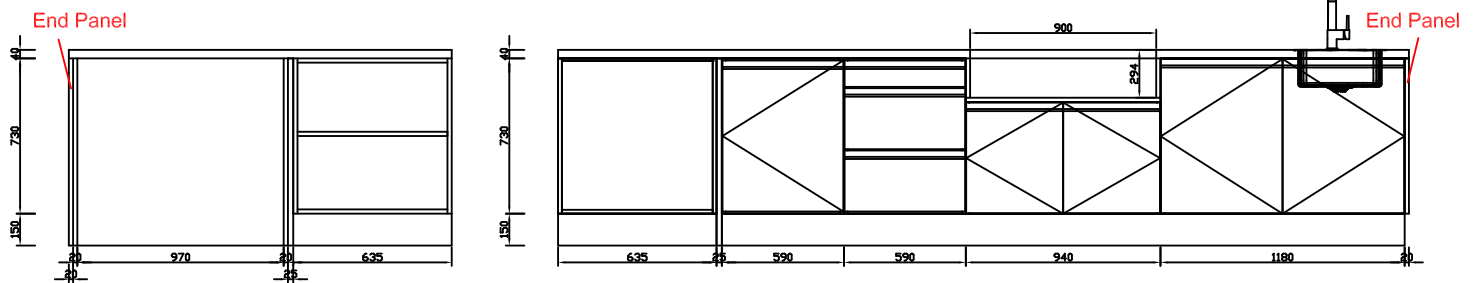

ALF-C2-840 Double Glass Door Alfresco Drink Chiller



- Water resistant (IPX4 rated)
- Designed for sheltered outdoor use
- 43°C tropical spec for usage in the Australian summer heat
- LED interior lighting controlled with on/off
- Digital temperature display
- 304 grade high quality stainless steel exterior and handle
- Self closing double-glazed door with heated glass and frame to prevent condensation
- Pressure injected foam insulation
- Integral lock/s to protect stock
- Fully adjustable chrome shelves every 11mm.
- Auto defrost with self-evaporating drip tray
- Adjustable feet to allow for level positioning on uneven floors
- Stainless steel compressor base plate
- Doors are not reversible



Specifications

MODEL	ALF-C2-840
CAPACITY	
Nett Total (Litres)	190
PERFORMANCE	
Power Input/Watts	213
Temperature Range (°C)	0 to 10
FEATURES	
Temperature Control	Electronic
Shelves	4 (extra available)
Feet	Adjustable
Door Hinge Location (Left to Right)	Left, Right
Refrigerant	R600a
330ml bottle loading capacity (hinged model)	190
500ml bottle loading capacity (hinged model)	150
DIMENSIONS	
Nett External HxWxD (mm)	840x865x495
Nett Weight (kgs)	63